

 MCE

part of the family
**HABAU
GROUP**



Welcome to MCE

MCE Firmenpräsentation | Franzosenhausweg 25, A-4030 Linz | MCE GmbH © 2022

part of the family
**HABAU
GROUP**

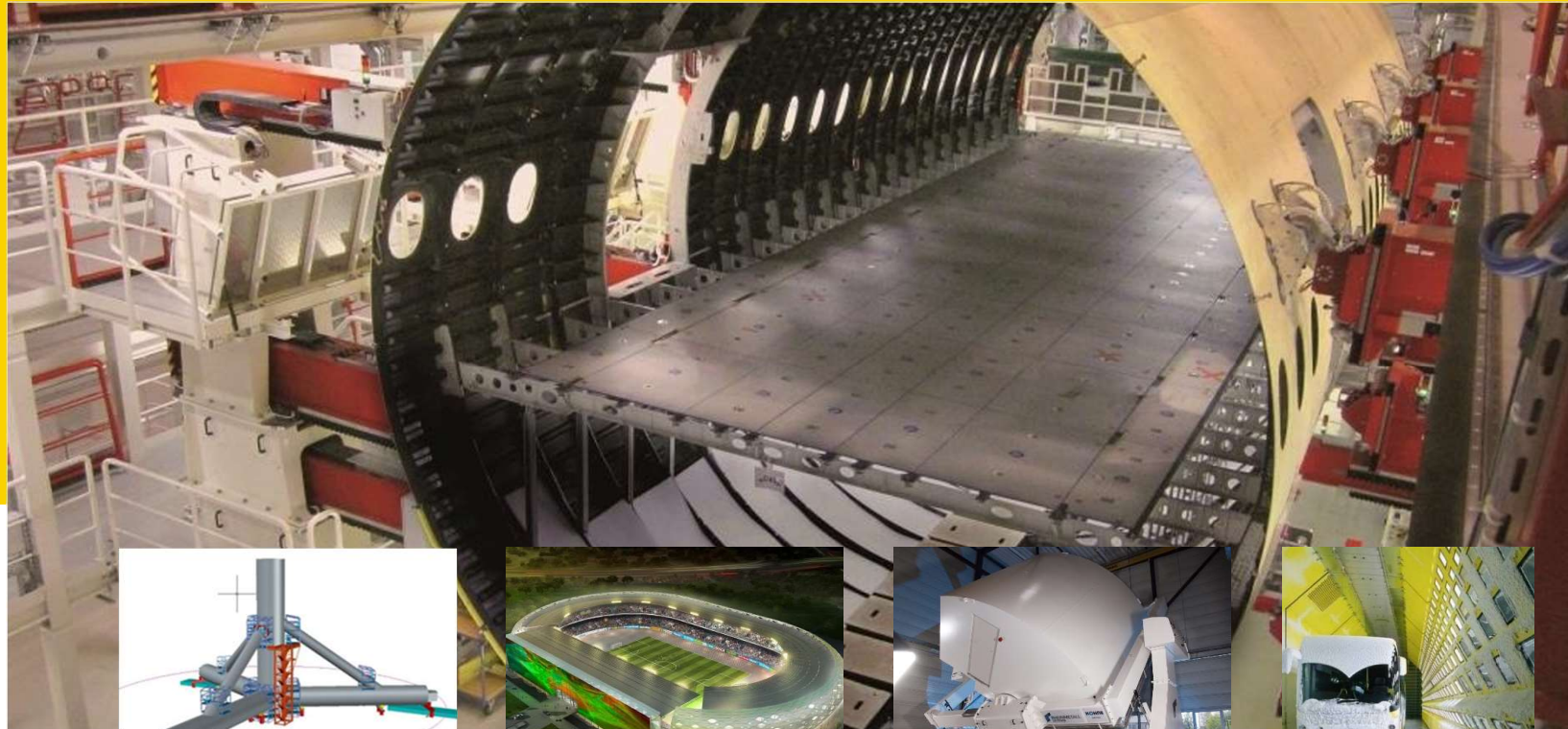

© Airbus

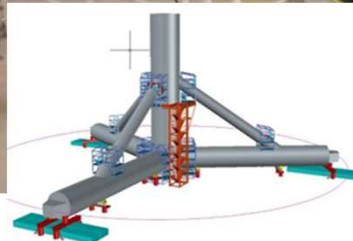

© MCE GmbH



© Bilfinger Berger Nigeria GmbH



© Rheinmetall



© RTA

ProS - Producton Solutions

MCE GmbH | Franzosenhausweg 25, A-4030 Linz © 2023

part of the family
**HABAU
GROUP**

History

1989

established as VOEST-ALPINE MCE developed into international system provider & service company



Foundation/Purchase of MCE Nyiregyháza

1998

Renaming to VA TECH VOEST MCE



2002

Andlinger takes over VA TECH's remaining shares of MCE VOEST

2008

Deutsche Beteiligungs AG and its buyout funds now hold 100% of MCE AG shares.

2012

MCE Stahl-und Maschinenbau GmbH & Co KG becomes Bilfinger MCE GmbH



Foundation/Purchase of MCE Slany

1991

partial takeover of VA TECH by Andlinger & Company Andlinger

2001



Foundation of MCE Stahl- und Maschinenbau GmbH & Co KG business units

- steel construction
- integrated structural steel plant construction

2004

Bilfinger SE strengthens industrial and power services: acquisition of MCE - integration in the business unit Industrial Services

2009

part of the family
HABAU GROUP

HABAU Hoch- und Tiefbaugesellschaft m.b.H. took over Bilfinger MCE GmbH and sign with the name MCE GmbH

2016

Organisation HABAU GROUP

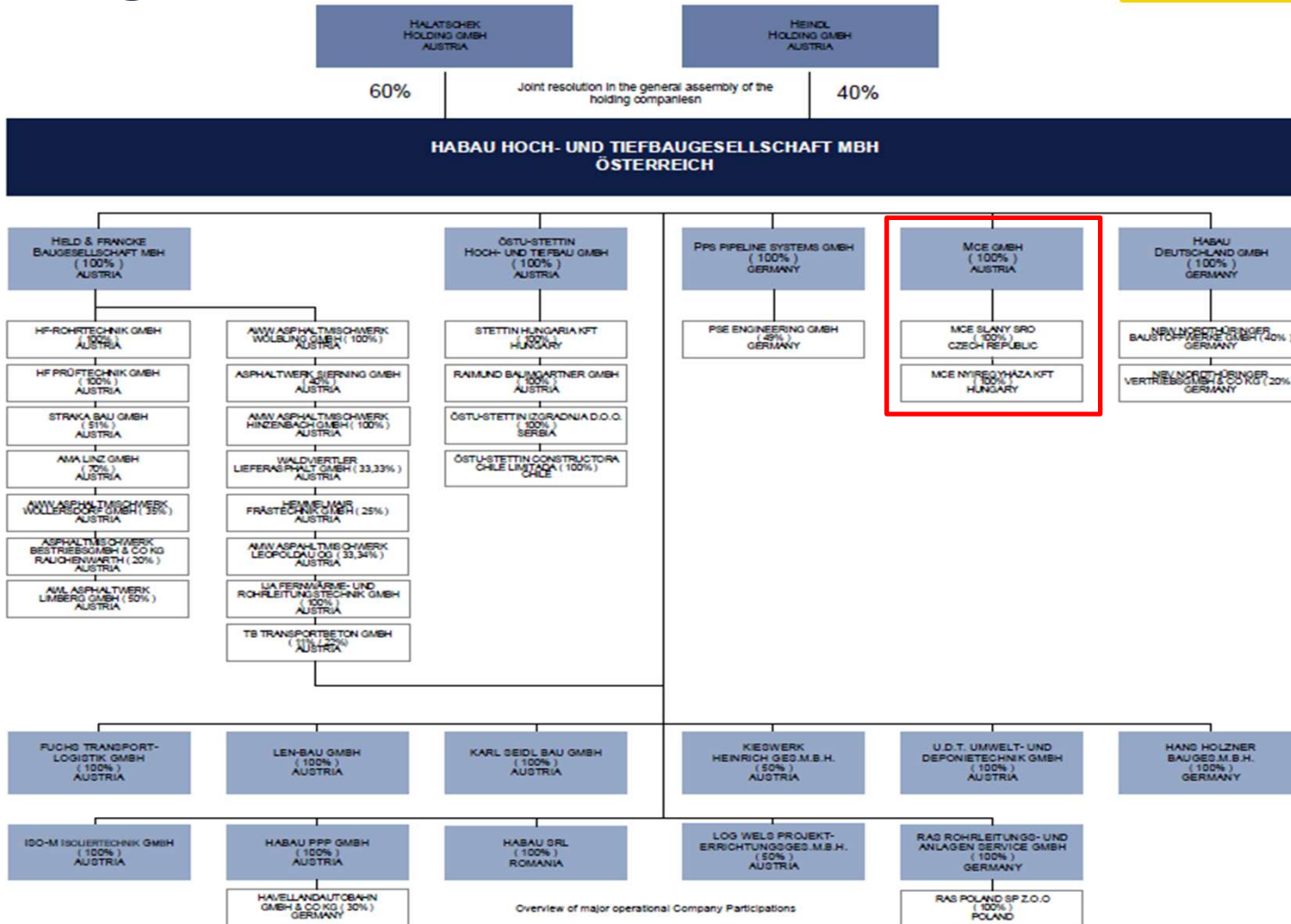

1,7 Billion EUR
Consolidated
Group Turnover in 22/23
approx.
6.000 Employees in 22/23

MCE GmbH - Products & Services



Bridges

- Pedestrian and cycle bridges
- Road and railway bridges
- Financed projects
- Bascule bridges



Steel Structures

- Stadiums
- Car parks
- Reconstruction of railway stations



Plants

- Jig construction
- Climatic wind tunnels
- Simulators
- Transport devices

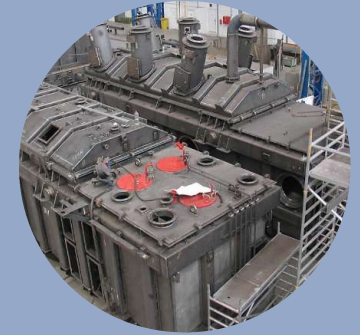

Energy

- Transformers
- GE-Frames

design – fabrication – assembly – implementation - maintenance

MCE GmbH – Preliminary Facts (22/23)

2 Business Units,

- Production Solutions (100% Export)
- Steel Bridges & Steel Hydraulics Construction (85% Export)

2 Subsidiaries

- MCE Slany (CZ)
- MCE Nyireghaza (HU)

Ø 150 Mio € Annual Sales

95% Export

550 Employees (incl. 75 externals)

Qualification of Employees

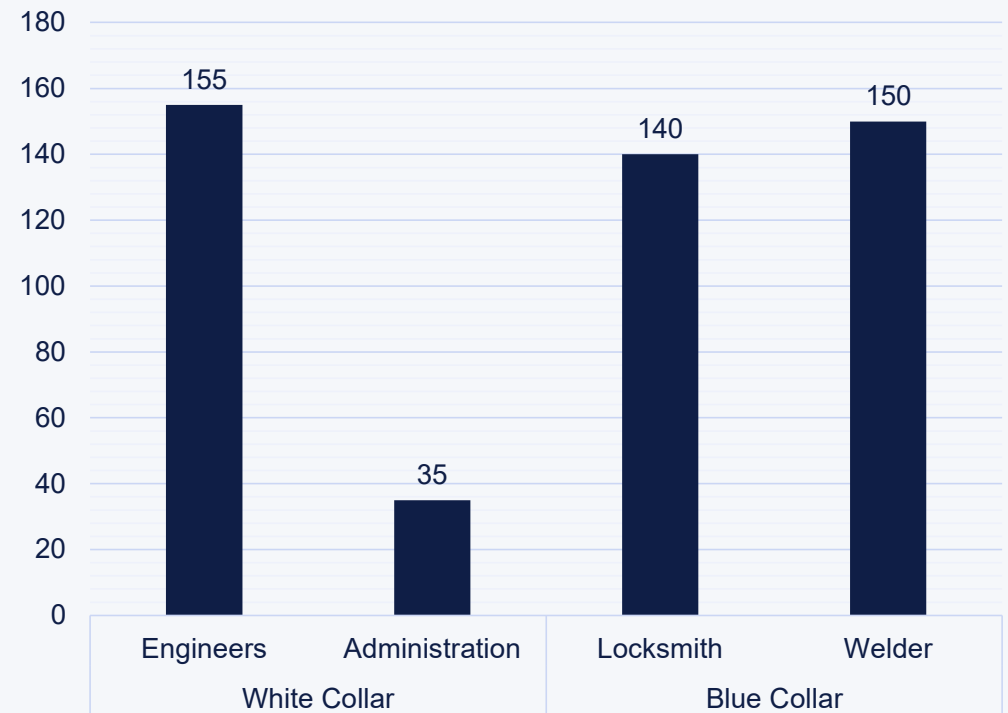

Locations

- Headquarter
- Office location
- Subsidiary
- Branch



MCE ProS - Strength

As part of the HABAU Group we are a family owned, Austrian company with a strong financial back bone. With this solid basis MCE GmbH is a **reliable Long-term partner** for any investments in the field of industrial plant building.



The long years' experience of MCE in **execution of complex Projects** are a guarantee for a successful implementation of your projects.



As a **General Contractor and Integrator**, we are integrating optimum solutions for our customer projects on a Turn-key basis.



Our project teams and experts respond to the requirements of our customers with **Tailor-made, Individual solutions**.



Our wide range of **Expert Know How in all relevant fields of Technology** allow us to offer technical solutions for demanding requirements.



MCE ProS – Our Scope of Work

Project management

Engineering

- Conceptual design & basic design
- Structural analysis
- Detailed design
- Technical specifications
- Technical interface management

Equipment supply

- Steel structures
- Mechatronic components
- Civil works
- Logistic & energy supply
- Electric and automation
- Measurement systems
- Command control & visualization

Quality assurance

- Quality management
- Document management
- Supply chain management

Installation, comissioning & training

After sales service

Certification



**Quality management:
ISO 9001**



**Occupational health
and safety:
ISO 45001**



**Environmental
protection:
ISO 14001**



**Energy management:
ISO 50001**



**Steel structures:
EN 1090-1**



**Corrosion protection:
RVS-15.05.11-WERK-
0004-2011**



**Fusion welding of
metallic materials:
ISO 3834-2**



**Welding certificate:
EN 1090-2**



**Welding of rail
vehicles: EN 15085**



**Anti-bribery management
system: ISO 37001**

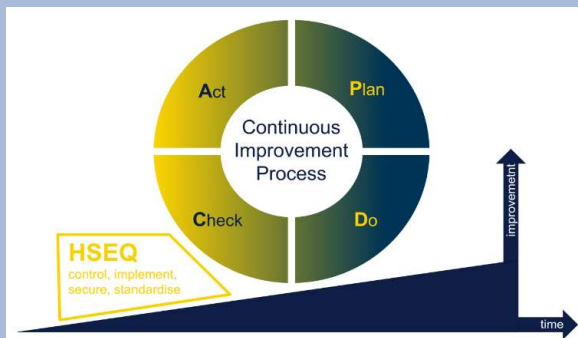

**QM for aerospace
industry: EN 9100**



**Prequalification
acc. § 6b VOB/A**



**Manufacturer-related
Product Qualification
is. by Deutsche Bahn
acc. DBS 918 005**

MCE ProS – Product groups

Transportation equipment for large and complex components

1

- special containers
- transport devices

- Weight optimization
- Rigidity and support of parts calculated and designed for flight transport
- Stress optimized load distribution to large components
- Air - Sea - Road - Transport of Aircraft parts

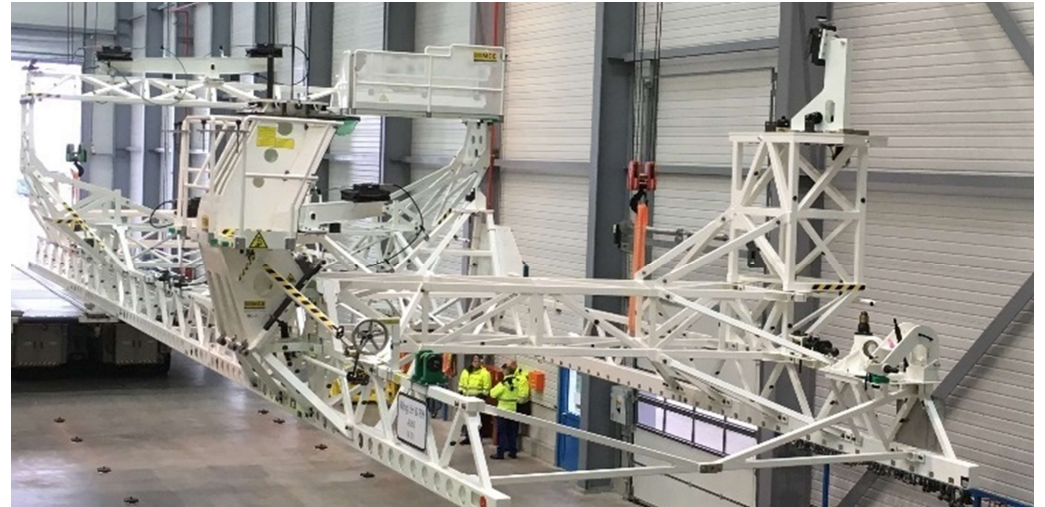

© MCE GmbH



© Airbus

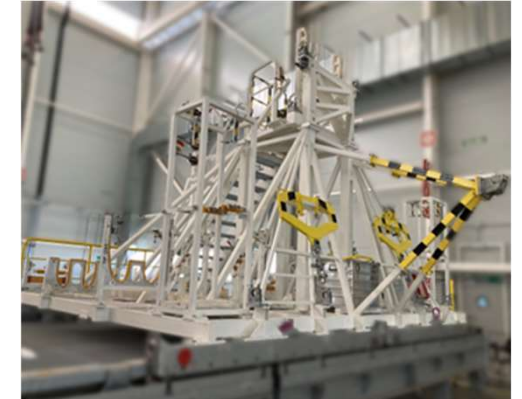

© Airbus

MCE ProS – Product groups

Assembly lines

2

- large components
- technological components

- Reliable coupling systems between cycle jigs
- Drives for individual cycle jigs
- Central drive for coupled jigs line
- Optimized logistics, accessibility and ergonomics



© MCE GmbH

MCE ProS – Product groups

Assembly lines

2

- large components
- technological components

- Optimized logistics, accessibility and ergonomics
- Operator safety systems
- Industry 4.0
 - HMI with detailed work steps logging
 - Quality data management
 - Data communication with central operation management system

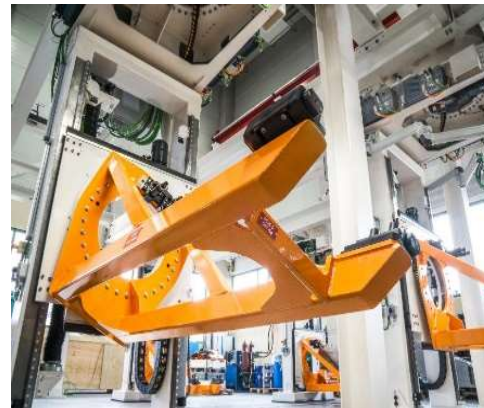

© MCE GmbH

MCE ProS – Product groups

Positioning and joining of parts

3

- geometry giving devices
- devices with automated positioning technology

- Geometric pallets for several work stations
- On a precise rail system
- With integrated access platforms

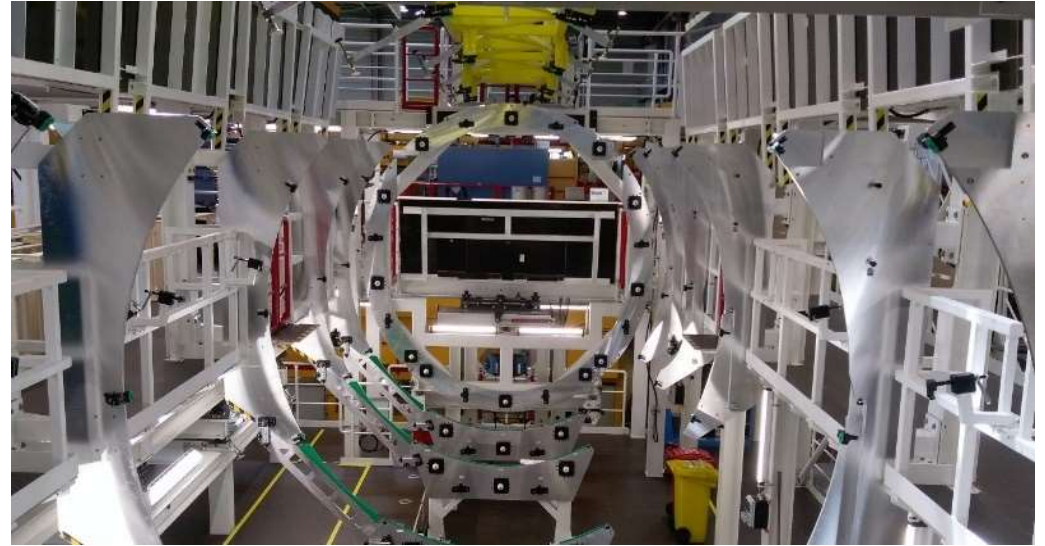

© MCE GmbH

MCE ProS – Product groups

Positioning and joining of parts

3

- geometry giving devices
- devices with automated positioning technology

- Automated assembly process
- High accuracy 3D measurement by laser tracker
- Best fit calculation for minimum tolerances
- Load controlled shaping and positioning of parts
- Industry 4.0
 - HMI with detailed work steps logging
 - Quality data management
 - Data communication with central operation management system

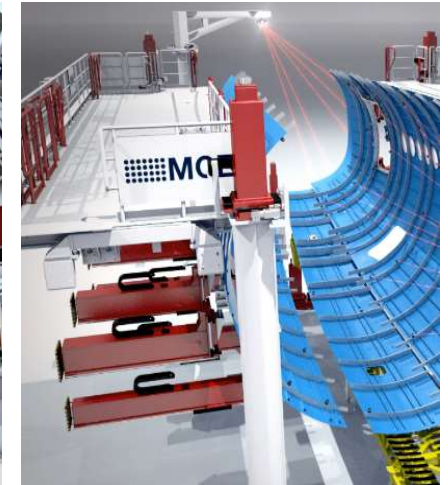

© MCE GmbH

MCE ProS – Product groups

Positioning and joining of parts

3

- geometry giving devices
- devices with automated positioning technology

- Automated assembly process and automated coupling of AC parts
- Best fit calculation for minimum tolerances
- Load controlled shaping and positioning of parts
- Hoisting device with integrated measurement assisted assembly
- Integrated command control system for standalone usage but also interaction with main station

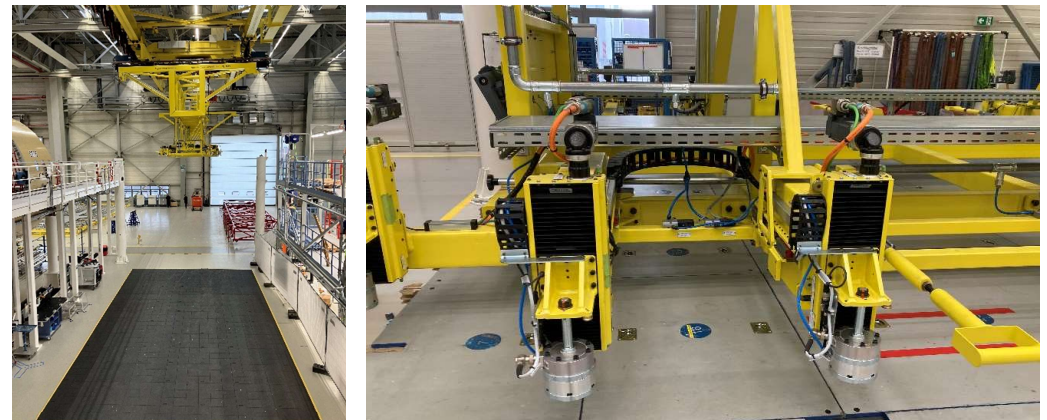
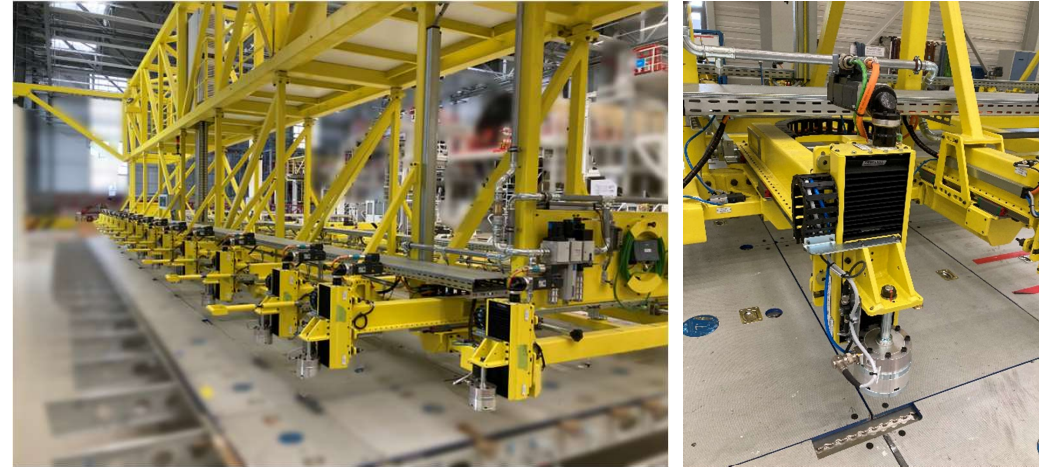

© MCE GmbH

MCE ProS – Product groups

Fixed, moveable and adjustable logistic access platforms

4

- steelstructure access platforms
- mobile platforms

- Complex multi-level access with more than 170 electric drives
- Steel and glass facade against fear of heights
- Media distribution for electrics, data network, hydraulics, pneumatics...



© MCE GmbH

MCE ProS – Product groups

Fixed, moveable and adjustable logistic access platforms

4

- steelstructure access platforms
- mobile platforms

- Complex movable platforms for access and logistic for e.g. FAL
- Complex upper wing platforms
- Flex Track integration
- Media distribution for electrics, data network, hydraulics, pneumatics..
- Integrated automated pallet gates for logistics



© MCE GmbH

MCE ProS – Product groups

Test facilities

5

- wind tunnels
- simulators

- Full scale testing of cars, trucks, trains, helicopters
- Impact simulation of sun, temperature, pressure, rain, snow, hail, sand, bird...

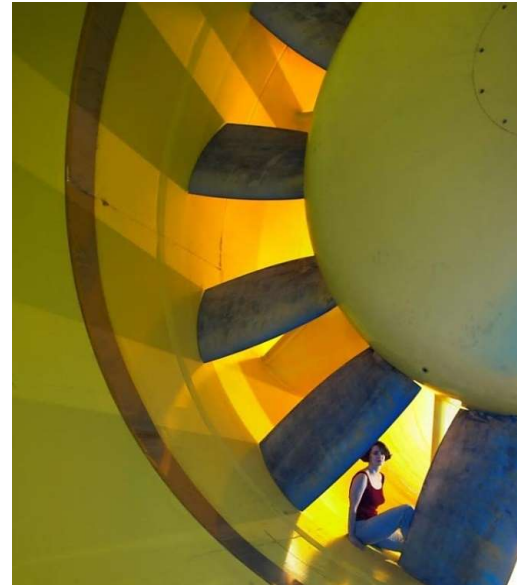

© MCE GmbH

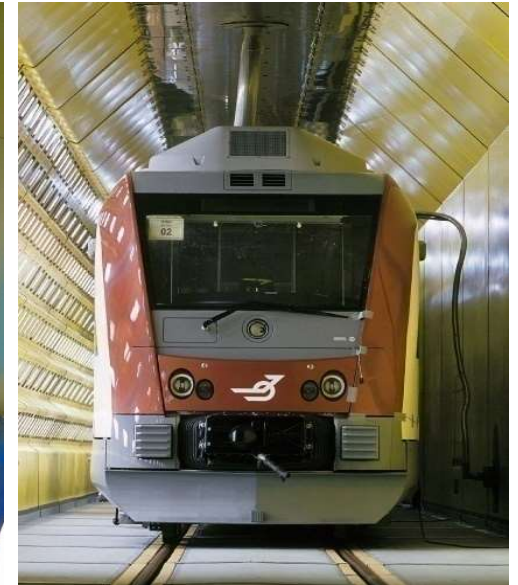

© MCE GmbH



© MCE GmbH



© MCE GmbH

MCE ProS – Product groups

Test facilities

5

- wind tunnels
- simulators

- Wind tunnels for aerodynamic, aeroacoustics, climatic testing
- Simulation of different tire/road surface condition
- Subsonic and Supersonic wind tunnels for aerospace applications
- Boundary layer wind tunnels for infrastructure testing
- Small scale testing of wind tunnel behaviour



© BMW



© RTA



© BMW

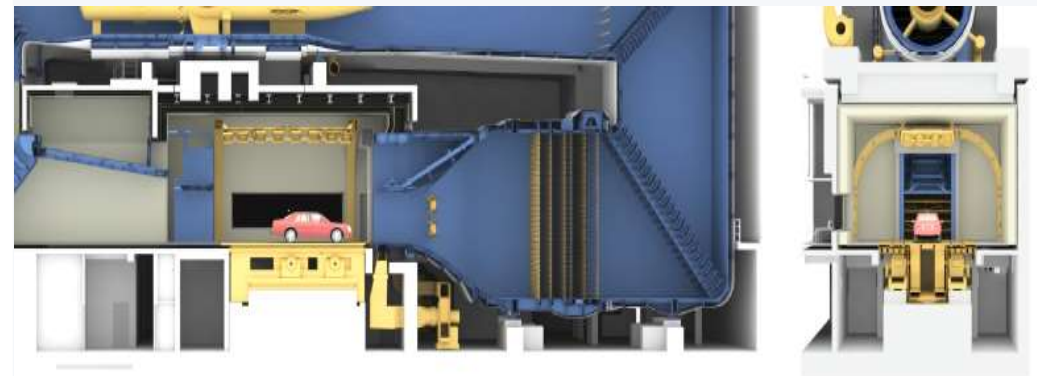

MCE ProS – Product groups

5

- wind tunnels
- simulators

Test facilities

- Submarine simulator
- Vehicle simulator
- Damage control trainer



© MCE GmbH



© Rheinmetall



© Rheinmetall

MCE ProS – Product groups

Complex steel structures

6

- building structures
- wind energy
- railway coaches

- Fabrication facilities for jackets of offshore windturbines



© Bilfinger Berger GmbH



© Bilfinger Berger GmbH

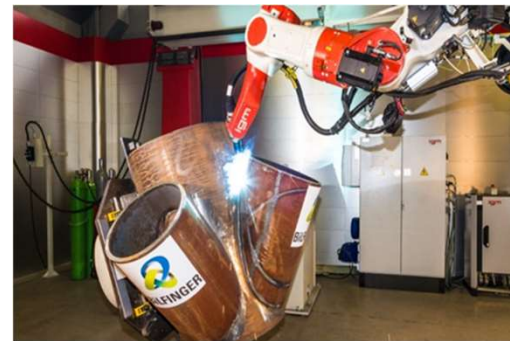

© Bilfinger Berger GmbH



© Bilfinger Berger GmbH

MCE ProS – Product groups

Complex steel structures

6

- building structures
- wind energy
- railway coaches

- Assembly yards for foundations of offshore windpower farms
- Floating platforms

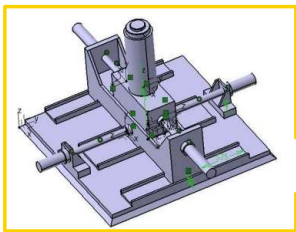

© MCE GmbH

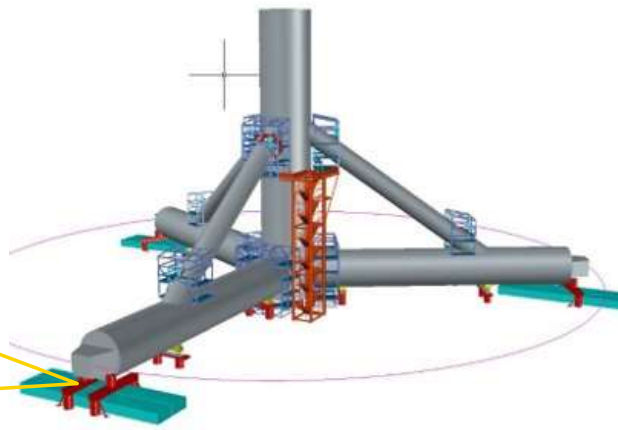

© MCE GmbH / SBM Offshore

MCE GmbH | Franzosenhausweg 25, A-4030 Linz © 2023

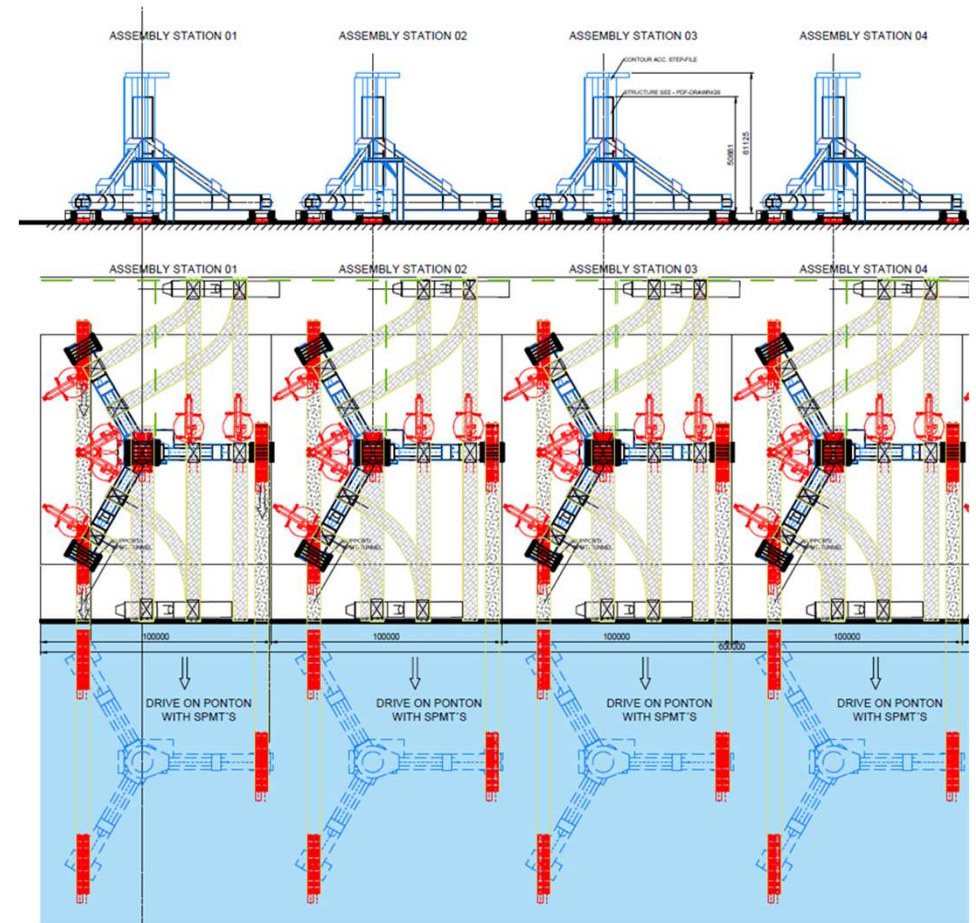

© MCE GmbH / SBM Offshore

MCE ProS – Product groups

Complex steel structures

6

- building structures
- wind energy
- railway coaches

- Fabrication and assembly lines for railway coaches
- Jigs and tools for railway fabrication

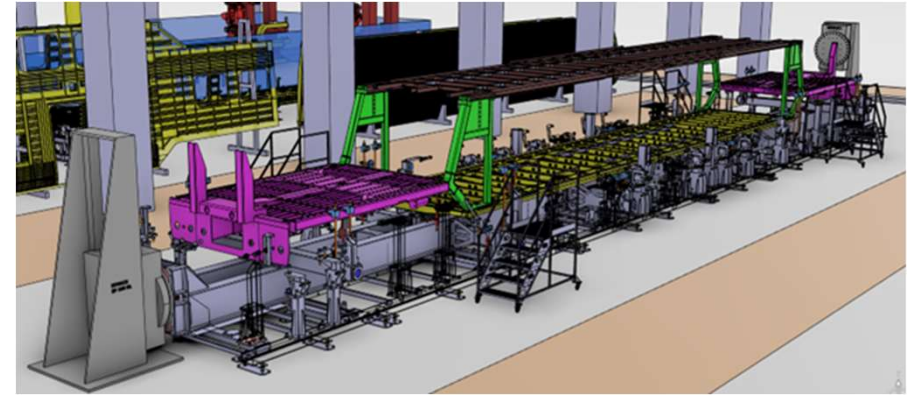

© MCE GmbH

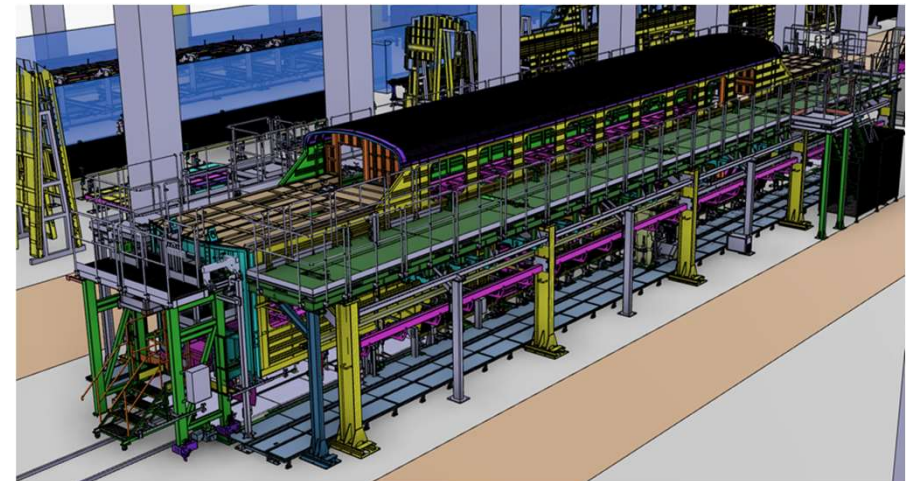

© MCE GmbH

7 Unit Handling of complex, large and heavy units on land and water



© MCE GmbH

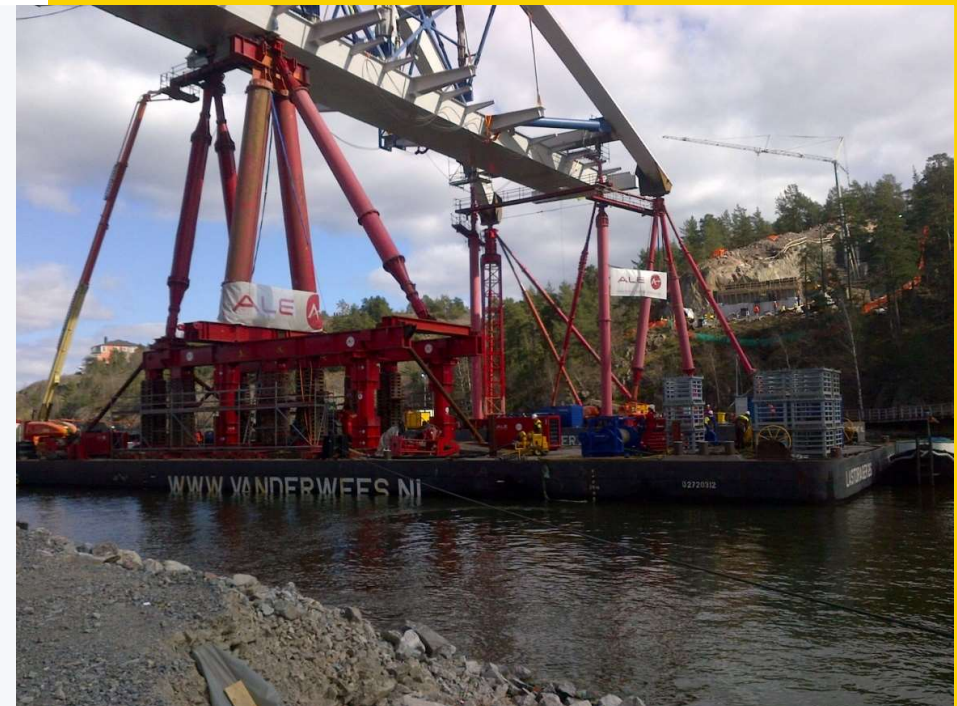

© MCE GmbH

Major Clients

from Aerospace, Railway and Automotive industry, Wind energy and Public sector, Universities and Research institutes



MCE GmbH

© MCE GmbH



Gregor NOPP
Head of Production Solutions BU

Christoph BÄCK
Head Commercial of Production Solutions BU

Bruno VIDAL
Head of Toulouse Branch

A Franzosenhausweg 25
4030 Linz / Austria
T +43 732 9011 – 8807
E stahlbauanlagen@mce-hg.com
W www.mce-hg.com

**performance
in construction
and plant engineering**

All rights reserved. Confidential and proprietary document. This document and all information contained herein is the sole property of MCE GmbH (MCE-A). No intellectual property rights are granted by the delivery of this document or the disclosure of its content. This document shall not be reproduced or disclosed to a third party without the express written consent of MCE-A. This document and its content shall not be used for any purpose other than that for which it is supplied.

The statements made herein do not constitute an offer. They are based on the mentioned assumptions and are expressed in good faith. Where the supporting grounds for these statements are not shown, MCE-A will be pleased to explain the basis thereof.

mce-hg.com

part of the family
**HABAU
GROUP**